

OFFICIAL E-SOUVENIR PROGRAM

GATEWAY DIRT NATIONALS



GATEWAY

Dirt Nationals

THE DOME AT AMERICA'S CENTER

PRESENTED BY:



TWO THOUSAND TWENTY ONE

ON THE ROAD AND ON THE TRACK, COUNT ON SUNOCO RACE FUELS FOR PERFORMANCE

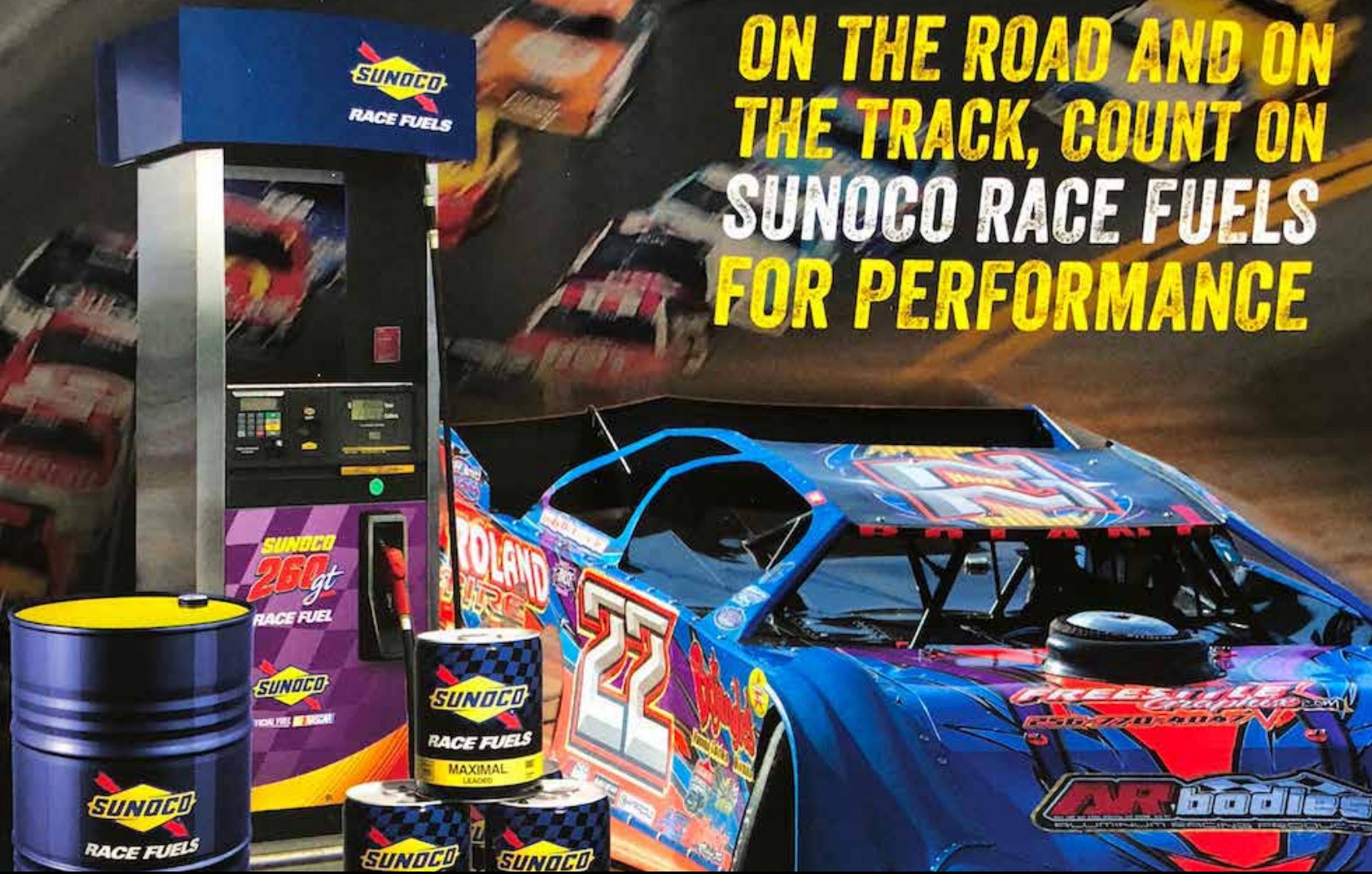

**WELCOME
RACE FANS
WELCOME**

RACING HAS BEEN A BIG PART OF WHO WE ARE FOR SIXTY YEARS.

O'REILLY AUTO PARTS STARTED IN 1957 as a single-store operation in Springfield, Missouri. The company was founded to help serve the area's growing need for an aftermarket parts alternative to the OE dealer.

FAST FORWARD 60 YEARS. Today, O'Reilly Auto Parts has grown to more than 5,100 stores in 47 states. We have thousands of replacement parts and maintenance items on hand, in stock and ready for installation. We also offer a complete line of auto body tools, paint and supplies, automotive tools and professional quality service equipment.

WE ARE ALSO EXTREMELY ACTIVE in the Motorsports industry. In fact, this year alone we will sponsor over 1,500 events, from local dirt track races to 8 NHRA Partner Tracks, 12 NASCAR Partner Tracks and NASCAR XFINITY Series & Monster Energy NASCAR Cup Series Events. Through Motorsports, we are able to connect with race fans who we know are some of our most loyal and valued customers.

THANK YOU for attending this year's event. Whether you're looking for quality auto parts or quality racing action, there's only one name you need to know - O'Reilly Auto Parts.

AUTOMOBILES ¥ LIGHT & HEAVY-DUTY TRUCKS ¥ OFF-ROAD EQUIPMENT ¥ BUSES & RECREATIONAL VEHICLES
¥ OFF-HIGHWAY ¥ AGRICULTURAL EQUIPMENT ¥ MARINE & MORE





WELCOME LETTER

WELCOME TO THE CASTROL GATEWAY DIRT NATIONALS

I would like to take this time to thank you for attending this year's event. The last three years of this event have been unbelievable due to the continuous support from drivers, teams, partners and fans! Without you, none of this would be possible! I strive to continue to work towards ways of improving this event and the overall experience for those in attendance. I am proud to have a strong team of great people that help make this all possible and I can assure you that we put everything we have into making this event what it is. As we go into the dome and under the lights for the 5th year in a row, I hope that your experience here with us is something that you will never forget. It is my goal that everyone inside of this building will experience "MOMENTS" which will last them a lifetime. In 2016, we had a battle for the ages on Friday night and will never forget crotch chop 2.0 from Scott Bloomquist at driver introductions. In 2017, we got to enjoy watching Jason Welshan call out one of the greatest drivers of all time, Scott Bloomquist, and the future of our sport, Bobby Pierce, take victory. In 2018, the addition of midgets took our event to the next level. The three divisions collectively produced an eclectic mix of racing action and motorsports personalities. Welcome to the Castrol Gateway Dirt Nationals presented by O'Reilly Auto Parts.



FOUNDER/PROMOTER

CODY SOMMER



2019 CHAMPIONS



TYLER CARPENTER



DEREK LOSH



EVENT SCHEDULE

SCHEDULE OF EVENTS DECEMBER 2-4, 2021

THURSDAY

10:00AM - REGISTRATION OPENS
10:30AM - VENDOR "EARLY ACCESS" ONLY
11:00AM - PIT AREA OPENS
1:00PM - DRIVERS MEETING (ROOM 130)
2:00PM - DOME DOORS OPEN
 MIDGET NIGHT 1 ENGINE HEAT
3:00PM - HOT LAPS (LM)
 HOT LAP QUALIFYING (MIDGETS)
 HOT LAPS QUALIFYING (MOD NIGHT 1)
 QUALIFYING (LM)
 OPENING CEREMONIES
 HEAT RACES (MIDGETS)
 HEAT RACES (LM)
 HEAT RACES (MOD)
 B-MAINS (LM)
 B-MAIN (MOD)
 A-MAIN (MIDGET NIGHT 1)
 A-MAIN (LM NIGHT 1)
 A-MAIN (MOD NIGHT 1)
9:00PM - REGISTRATION & CREDENTIALS CLOSES
9:00PM - FUEL STORAGE CLOSES
 PITS ARE CLEARED, DOORS ARE CLOSED 1 HOUR AFTER LAST CHECKERED FLAG

FRIDAY

10:00AM - REGISTRATION OPENS
10:30AM - VENDOR "EARLY ACCESS" ONLY
11:00AM - PIT AREA OPENS
1:00PM - DRIVERS MEETING (ROOM 130)
2:00PM - DOME DOORS OPEN
 MIDGET NIGHT 2 ENGINE HEAT
3:00PM - HOT LAPS (LM)
 HOT LAP QUALIFYING (MIDGETS)
 HOT LAPS QUALIFYING (MOD NIGHT 2)
 QUALIFYING (LM)
 OPENING CEREMONIES
 HEAT RACES (MIDGETS)
 HEAT RACES (LM)
 HEAT RACES (MOD)
 B-MAINS (LM)
 B-MAIN (MOD)
 A-MAIN (MIDGET NIGHT 2)
 A-MAIN (LM NIGHT 2)
 A-MAIN (MOD NIGHT 2)
9:00PM - REGISTRATION & CREDENTIALS CLOSES
9:00PM - FUEL STORAGE CLOSES
 PITS ARE CLEARED, DOORS ARE CLOSED 1 HOUR AFTER LAST CHECKERED FLAG

SATURDAY

10:00AM - REGISTRATION OPENS
10:30AM - VENDOR "EARLY ACCESS" ONLY
11:00AM - PIT AREA OPENS
1:00PM - DRIVERS MEETING (ROOM 130)
2:00PM - DOME DOORS OPEN
 MIDGET ENGINE HEAT
3:00PM - LAST CHANCE QUALIFIERS (LM)
 HOT LAPS (LOCKED IN LM)
 LAST CHANCE QUALIFIERS (MOD)
 HOT LAPS (LOCKED IN MOD)
 PRE-RACE SHOW
 OPENING CEREMONIES
 DRIVER INTROS (LM)
 A-MAIN (LATE MODEL)
 DRIVER INTROS (MIDGET)
 A-MAIN (MIDGET)
 DRIVER INTROS (MOD)
 A-MAIN (MOD)



DIRT TRACK FANTASY SPORTS IS FINALLY HERE

DOWNLOAD
FOR FREE ON

Download on the
App Store

ANDROID APP ON
Google play



 /DIRTDRAFT

 @DIRTDRAFT

DIRTDRAFT.COM



EVENT PIT MAP

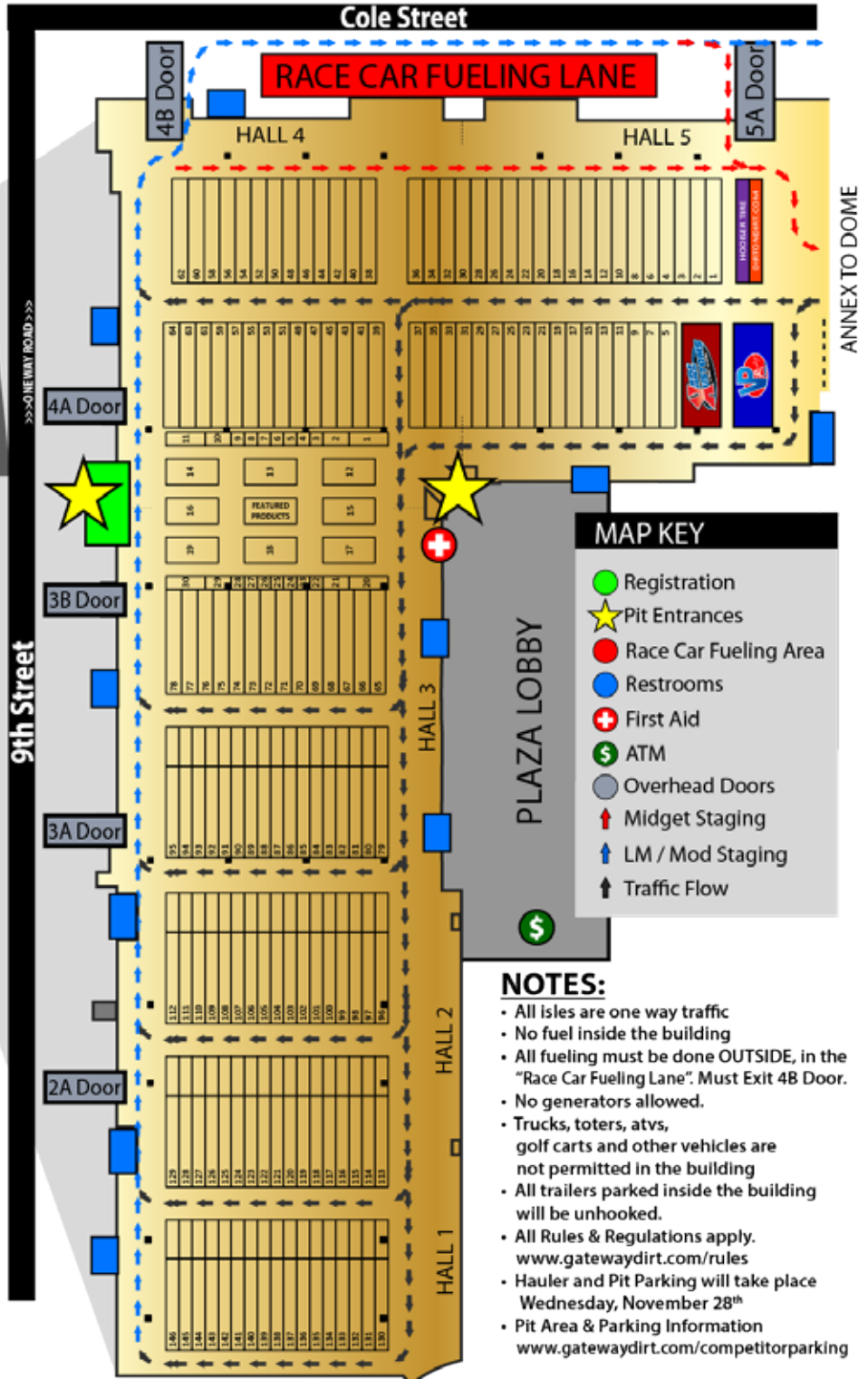

Tentative and Subject to Change



NOS

ENERGY DRINK

The Original Racing Shirt®

SINCE 1974

QUALITY TRUMPS PRICE. IT'S AS SIMPLE AS THAT!

- Industry Leader in Quality
- Guarantee Fade-Free Ink
- Active Industry Contributor

High Performance Shirt Specialists to Tracks,
Special Events, Racing Sanctions, Drivers & Crews

OFFICIAL SPONSOR OF



WE SUPPORT RACING.
THANKS FOR SUPPORTING US!



100 Gasoline Alley Indianapolis, IN 46222

www.arizonasportshirts.com

facebook.com/arizonasportshirts

[@AZ_Shirts](https://twitter.com/AZ_Shirts)

800-922-9918



THERE'S A REASON WE'VE BEEN AROUND OVER 40 YEARS...



GATEWAY DIRT BY THE NUMBERS

7,000 Yards of Dirt
350 Truck Loads
14,000,000 Lbs of Dirt
182 Fence Panels
1,730 Feet of Steel Tubing
3,750 Feet of Fence Cable
18,250 Sq ft of Banner
32,000 Sq ft of Endzone coverings
288 Jersey Barriers
1,152,00 Lbs
181 Employees
7,726 Hours of labor
Broadcasted to 44 states
6 provinces...
and 4 countries
1.... GAME CHANGING EVENT



EVENT OVERVIEW MAP

MAP KEY

Pit Entrances

- Pit Passes/Registration
- Race Car Fueling Area
- Public Entrances - MAIN Entry A
- Room 132 - VIP Club
- Room 131
- Room 130 - Media Center

Entry A is Main Public Entrance.
 Broadway Central Entrance will only be open Friday-Saturday

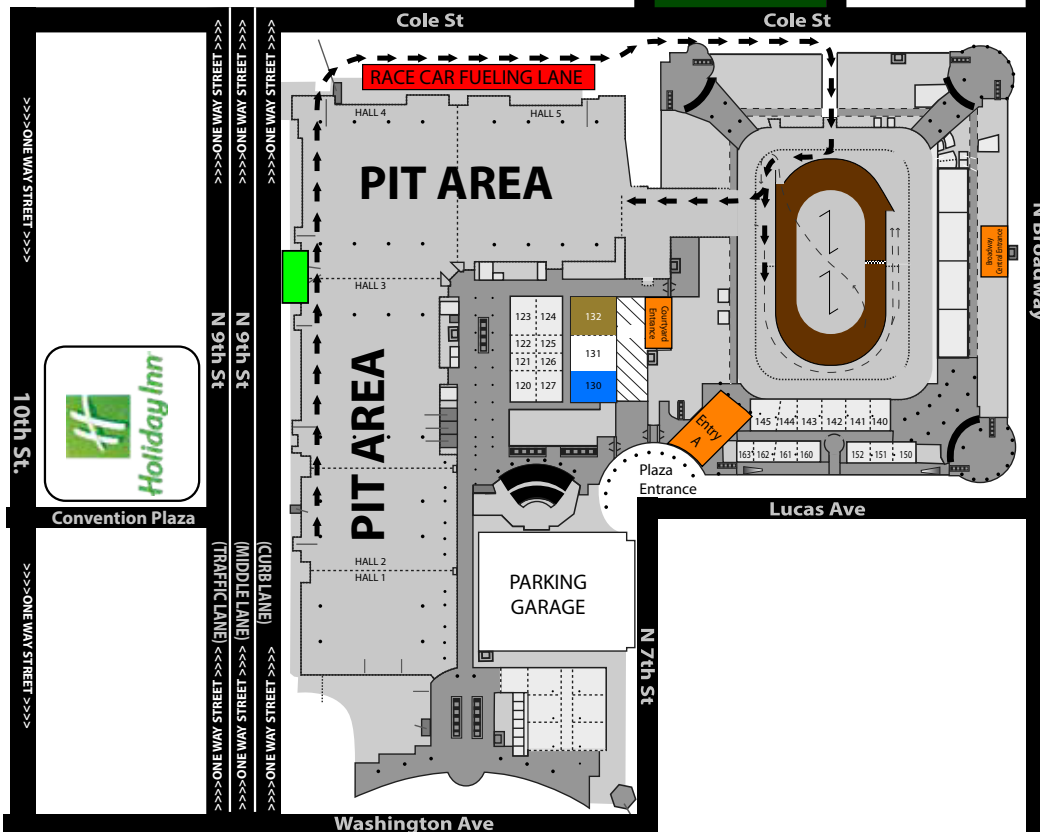
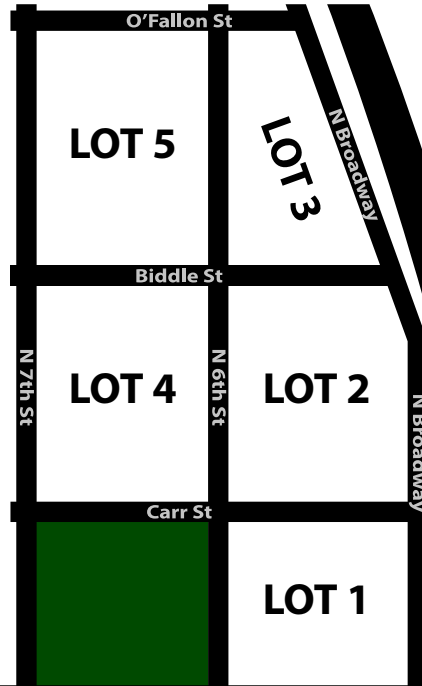

Map is Tentative and Subject to Change



NIGHT OWL DESIGN

SCOTT BLOOMQUIST



MIKE MARLAR



NICK HOFFMAN



KYLE HAMMER



**DRIVE FAST
- TAKE CHANCES**

Racer-Owned and Operated Manufacturer of:

Premium Custom Racing Suits | Racing Crew Apparel

Top Quality Racing Shoes | Single- & Dual-Layer SFI Gloves

Race-Ready Helmets & Accessories



Velocità

Premium Motorsports Apparel

336.721.5064

www.Velocita-USA.com

336.764.8513



EVENT SEATING MAP

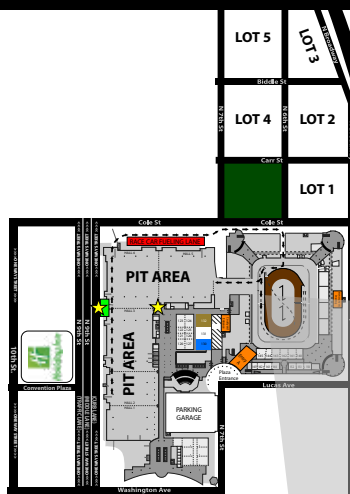

MAP KEY

- Annex/Pit Entrance
- Private Section
- Jumbo Screen
- Race Staging

KEY LOCATIONS

First Aid
(Section 110 & 129)

Guest Services
(Section 117 & 145)

Price Levels:

- TIER 1
- TIER 2
- TIER 3
- PIT PASS SEATING AREA

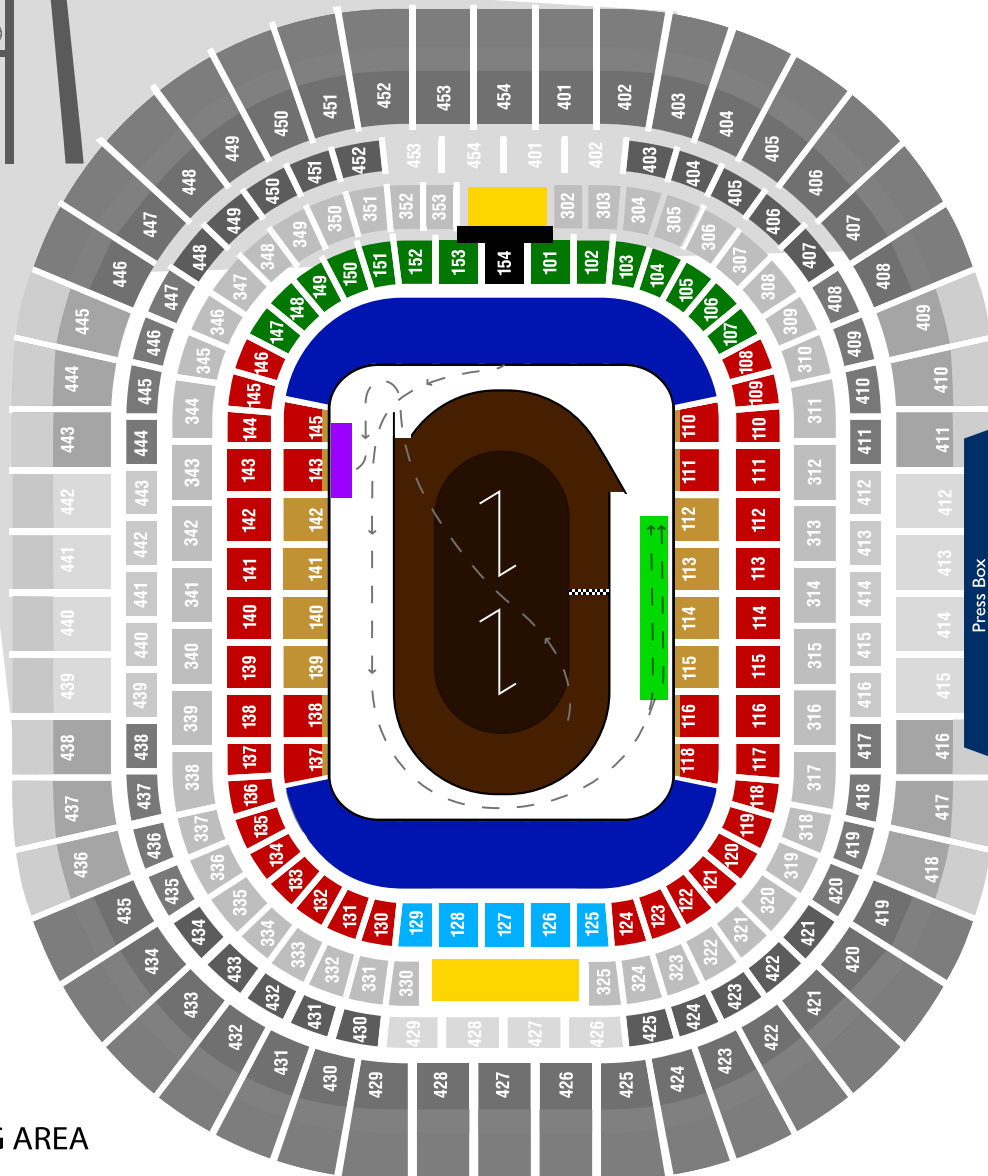

Tickets available at www.gatewaydirt.com/tickets

Gray-Scaled Areas are not currently available. Additional Seating will be opened up upon demand

Tentative and Subject to Change

Carry On The Tradition

Our America Depends on You . . .

About the ISRA

The purpose of the Illinois State Rifle Association (ISRA) is to:

- Support and protect the rights and freedoms of all citizens protected by the Bill of Rights under the United States Constitution.
- Assist the Civilian Marksmanship Program and its Director with the Promotion of Rifle Practice Firearm Safety.
- Promote the highest degree of sportsmanship and good fellowship.
- Promote and assist in the planning, construction, and preservation of civilian shooting ranges.
- Educate the citizens on all matters affecting the lawful use and possession of firearms, firearm safety, self-defense, competitive shooting and sport hunting.
- Support & promote the purposes, goals and objectives of the National Rifle Association of America and USA Shooting.



Since 1903



Join us at: www.isra.org

Illinois State Rifle Assn • PO Box 637 Chatsworth, IL 60921 • 815.635.3198





PEM Quick Change Rear Ends

- **Modified**
- **Late Model**
- **Rebuild Service for All Brands**



Quick Change Gear Sets

Premium LW Polished & Standard



9 inch Ford Rear Ends

- **Housings**
- **Center sections**
- **Gears, Spools, Yokes, Bearings, Installation Kits**



Racing and Performance Drive Shafts

- **Carbon Fiber**
- **Aluminum**
- **Steel DOM**
- **Chrome Moly**



Do you want to drive newer equipment and work for a smaller family-based company? Hoker Trucking is the company for YOU!

**ON THE RACE TRACK
OR ON THE ROAD,
WE DELIVER!!!
HOKERTRUCKING.COM
563.843.2763**

Proudly Built in the Midwest, just 45 miles west of St. Louis on I-44

636.629.6200

425 Industrial Park Dr. St. Clair, MO 63077

Engineered To Finish First.



MASTER
REFERENCE
GUIDE

The Absolute Leader In Valve Train Technology



COMPCAMS.COM | 1.800.999.0853

REINVENTING FIRST RESPONDER SAFETY

With quality as our foundation, we provide products, services, and support for first responders around the world.



BLUE

RED

AMBER

OUR FACILITIES

OVER 750,000 SQUARE FEET OF ENGINEERING AND MANUFACTURING SPACE IN CONNECTICUT AND NEW HAMPSHIRE



EVERYTHING YOU
NEED



FOR ANYTHING YOU
DRIVE



RACING • HOT ROD • TRUCK • JEEP • OEM • POWERSPORTS • TOOLS



**Champions Choose
Dyer's Top Rods.**

Shouldn't Dyer's
Be YOUR Choice?



JONATHAN DAVENPORT
Lucas Oil Late Model Dirt Series Champion - Street Nutter Nationals
Corsett Racing Engines



MIKE MARLAR
Craftsman World of Outlaws Champion - Wild West Shootout Champion
Corsett Racing Engines



CHAD SIMPSON
Lucas Oil M&M's Series Champion
Jag Dickson Racing Engines



CASEY ROBERTS
Schaer's 80 Southern Nationals Champion
Vic Hill Racing Engines



BRIAN SHIRLEY
SMP 800Car Summer Nationals 500 Year
Champion - Durham Racing Engines



KYLE BERCK
Mahlers Bank Super Late Model Series Champion
Sean Ralby Racing Engines



RUSTY SCHLENK
SMP 800 National Champion
ECR Racing Engines



CHRIS MADDEN
Frostburg 100 Winner
Clemens Racing Engines



BRANDON OVERTUN
Hillbilly 100 Winner
Clemens Racing Engines



JIMMY OWENS
Knoxville Late Model Nationals Winner
Durham Racing Engines



RICKY WEISS
Berkshire 100 Winner
Vic Hill Racing Engines



JOSH RICHARDS
Dirt Track World Championship
Durham Racing Engines



BOBBY PIERCE
Pittsburgh 100 and Jackson 100 Winner
Fit Power Racing Engines



www.DyersRods.com | 1-800-TOP-RODS | Fax: 815.657.9972 | E-Mail: roger@dymersrods.com

Our connecting rods are manufactured from 5010s steel forgings, which is 20% stronger than 4340 steel. The unique H Beam design, with a double beveled end for ultimate strength to weight ratio. Dyer's 400cc ARP Rod Ends: 3/8" ARP0000, ARP DA 425 Plus, ARP 3.5, 1/2" ARP 2000, ARP DA 425 Plus, ARP 3.5



**MADE
IN USA**

**FK
ROD
ENDS** Precision Rod Ends & Spherical Bearings



MADE IN THE U.S.A



EST. 2011

**TOP NOTCH PRODUCTS
FOR TOP NOTCH RACERS**

800-430-RACE



440CI LS Dirt Late Model Engine

Since 2011 Baldwin Racing Engines has lead the way in developing and running LS series engines on dirt. The overall durability, drivability, and upfront/upkeep cost of the LS are unmatched. BRE offers Late Model packages ranging from 430-447cu.in. and 850-915 hp with 685-735 ft.lbs. of torque; as well as Open Wheel Modified & Sprint Car engines. With lightweight championship proven engine packages perfect for small or large dirt tracks, the time to order is now! Late Model engines start at \$26,500.00!



573-788-2329

FOR A FIT ENGINE, CHOOSE CASTROL ACTIV WITH 3X PROTECTION.



3X PROTECTION

IT'S MORE THAN JUST OIL. IT'S LIQUID ENGINEERING.™

Castrol
Activ

#3XProtectionKeepsEngineFit

For more on 3X protection, visit 3xprotection.com or visit us on Facebook and YouTube. © 2014 Castrol. All rights reserved. Castrol, the Castrol logo and Castrol Activ are trademarks of Castrol. All other trademarks are the property of their respective owners.

HOOSIER RACING TIRE

TIRES DESIGNED FOR CHAMPIONS

Hoosier
RACING TIRE



SWITCH_R 



- The most powerful micro-receiver available for professional racers.
- The only device in its category with two preset buttons and the technology to support PL and DPL.
- Two-way radio is routed through the input while connecting your earbuds to the output, allowing one earpiece to hear both audio sources with incredible clarity.
- Lockable keys.

Visit the Racing Electronics location today,
or email Chris Michael at
chris.michael@racingelectronics.com

#CHAMPIONSWEARBELL

#ANYSURFACEANYSPEED

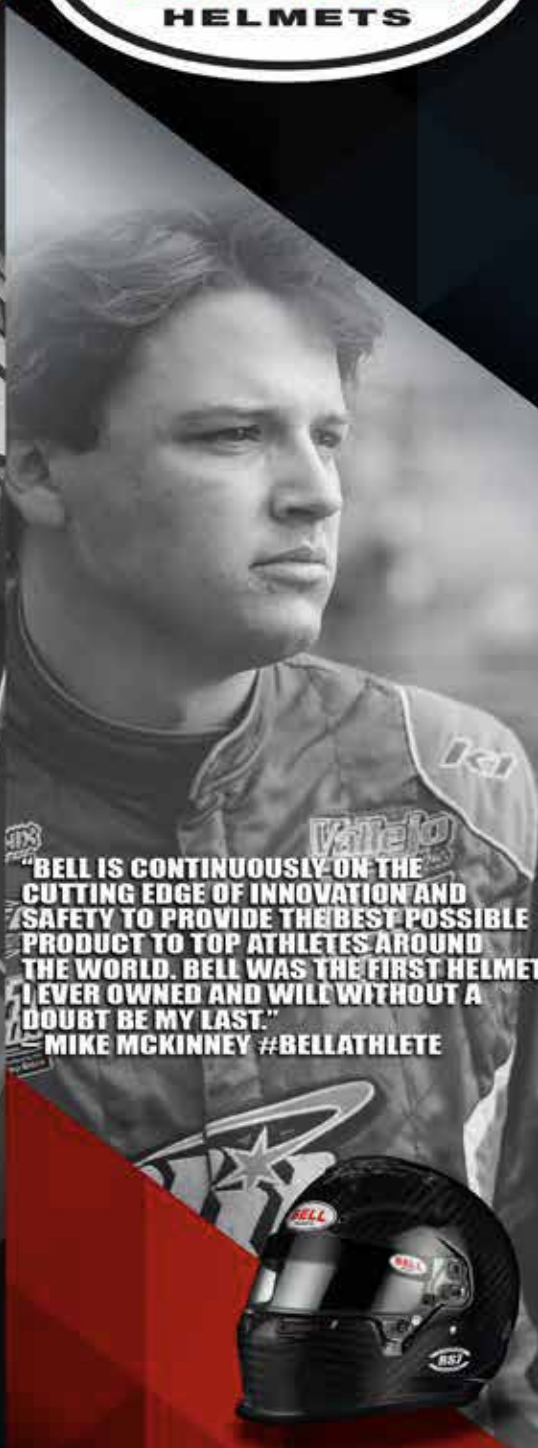

"BELL IS CONTINUOUSLY ON THE CUTTING EDGE OF INNOVATION AND SAFETY TO PROVIDE THE BEST POSSIBLE PRODUCT TO TOP ATHLETES AROUND THE WORLD. BELL WAS THE FIRST HELMET I EVER OWNED AND WILL WITHOUT A DOUBT BE MY LAST."

MIKE MCKINNEY #BELLATHLETE

"BELL HELMETS NOT ONLY HAVE THE BEST PRODUCT ON THE MARKET, BUT ALSO HAVE UNRIVALED CUSTOMER SERVICE AND TRACKSIDE SUPPORT."

- JUSTIN GRANT
#BELLATHLETE

"WHEN I PUT MY BELL ON, EVERYTHING IS RIGHT IN THE WORLD. THEY'RE THE MOST COMFORTABLE FITTING HELMETS I HAVE EVER USED, AND I LOVE THE SUPPORT AND SERVICE THEY OFFER TO THEIR ATHLETES AND CUSTOMERS."

- BOBBY PIERCE
#BELLATHLETE



f @BELLRACINGUSA

t @BELLRACINGUSA

i @BELLRACINGUSA

WWW.BELLRACING.COM



BELL RACING INDY
SPEEDWAY PRO SHOP
1330 MAIN STREET
SPEEDWAY, INDIANA 46224

BELL RACING USA LLC
301 MERCURY DR, #8
CHAMPAIGN, ILLINOIS 61822

The Devil is in the Details

Engineering Performance Since 1967



WELD[®] RACING

weldracing.com

 **WELD**
MADE IN THE USA



GO LITHIUM
INTELLIGENT POWER

WALKER
PERFORMANCE FILTRATION
MADE IN USA - (818) 252-7788



CAMBER DRIVE FLANGE 2°

FITS

WIDE 5 RACING HUBS



CAMBER DRIVE FLANGE

- Two degrees of misalignment
- Heat-treated components for added strength
- Works with all 24-spline axles

Engineered and manufactured in the USA for durability and long life

NEW PRODUCT

WILWOOD RACING

DIRT / LATE MODEL

Forged
Narrow
Dynalite



- Strongest Caliper in its Class!
- Superior Bridge Strength
- Top Loaded Pads



wilwood